

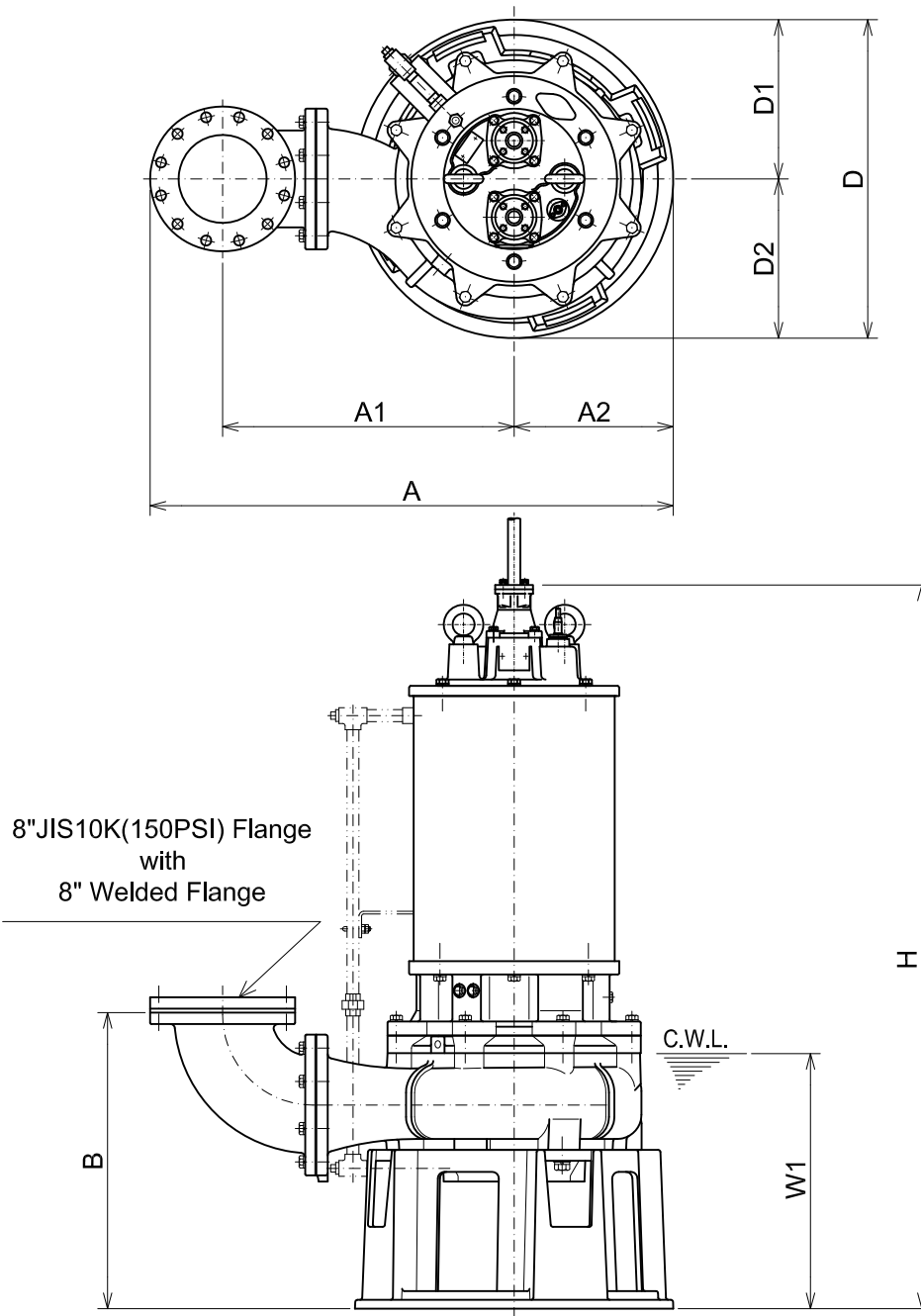

**B-SERIES  
SEWAGE & WASTEWATER PUMPS**

**DIMENSIONS**

**200BK437 -63**



C.W.L. :Continuous running Water Level

**DIMENSIONS:USCS(Inch)**

Model	HP	NOM. SIZE	Pump & Motor								C.W.L.	*Wt.
			A	A1	A2	B	D	D1	D2	H	W1	(lbs.)
200BK437 -63	50	8"	46 7/8	26 1/8	14 1/4	26 1/2	28 1/2	14 1/4	14 1/4	64 9/16	22 7/8	1870

**DIMENSIONS:METRIC(mm)**

Model	kW	NOM. SIZE	Pump & Motor								C.W.L.	*Wt.
			A	A1	A2	B	D	D1	D2	H	W1	(kg)
200BK437 -63	37	200	1190	663	362	673	724	362	362	1640	580	850

\*Excluding Cable