

PARTS LIST		SEWAGE & WASTEWATER PUMP			4/18/2014	
ITEM	PART No.	DESCRIPTION	QTY	SIZE	MATERIAL	NOTES
1	009-127-14	Terminal	4	R-1.25-4	CU	
2	140-427-17	Hex.Bolt (w/Plain Washer)	2	M5x15	SUS304	
3	003-190-10	Gland	1		SUS316	
4	001-006-56	Cabtyre Cable Set (10m)460V-60Hz(USA)	1	VCT4Cx1.25mm2	LBT	
5	009-104-15	Solderless Terminal	4	TMVB-1.25	CU	
6	009-117-11	Terminal	7	R-22-6	CU	
7	001-535-15	Cabtyre Cable (Sold per meter)460V-60Hz(USA)	10	2PNCT4Cx22mm2	(Vm)	
8	140-056-11	Hex.Bolt	8	M8x30	SUS304	
9	141-005-18	Hex.Nut	8	M8	SUS304	
10	003-188-15	Gland	2	BG3(30-4P)	FC	
11	005-139-17	Bush Washer	2	d33xd53.5x3t	SUS304	
12	004-111-23	Cable Bush	1	No.6A	SBR	
13	140-076-17	Hex.Bolt	8	M10x30	SUS304	
14	142-164-19	Spring Washer	8	M10	SUS304	
15	006-162-12	Stuffing Box	2	BG3	FC	
16	001-533-13	Cabtyre Cable (Sold per meter)460V-60Hz(USA)	10	2PNCT3Cx22mm2	(Vm)	
17	005-138-16	Bush Washer	2	d29xd53.5x3t	SUS304	
18	004-110-19	Cable Bush	1	No.6	SBR	
19	009-107-18	Terminal	6	R-14-6	CU	
20	143-041-12	Pan Screw	7	M6x8	SWRM	
21	141-004-59	Hex.Nut	7	M6	SWRM	
22	009-117-11	Terminal	7	R-22-6	CU	
23	002-115-18	Heat Shrink Tube (Sold per meter)	m	EVA(d16.5x1t)	(Vm)	
24	002-116-19	Heat Shrink Tube (Sold per meter)	m	A4(d20x0.35t)	(Vm)	
25	122-132-16	O-Ring	2	G-105(104.4xd3.1)	NBR	*
26	143-041-12	Pan Screw	1	M6x8	SWRM	
27	009-106-17	Terminal	2	R-8-6	CU	
28	046-000-03	Air Release Valve	1	PT-1/2	SUS304	
29	217-000-18	Fixing Plate	1		FC	
30	122-359-11	O-Ring	1	445xd5.7	NBR	*
31	140-102-13	Hex.Bolt	6	M12x55	SUS304	
32	142-165-10	Spring Washer	6	M12	SUS304	
33	142-000-47	Washer	6	M12(d12.5xd25.5x5t)	SUS304	
34	121-513-12	Seal Packing	6	d11.5xd21x4t	CR	*
35	122-353-15	O-Ring	1	310xd5.7	NBR	*
36	072-108-28	Eye Bolt	2	M30	SUS304	
37	035-113-18	Oil Plug	1	M12x14	SUS304	
38	121-247-12	Packing	1	d12.3xd18x2t	PE	*
39	140-100-11	Hex.Bolt	6	M12x45	SUS304	
40	142-165-10	Spring Washer	6	M12	SUS304	
41	050-000-76	Motor Bracket	1		FC	
42	122-353-15	O-Ring	1	310xd5.7	NBR	*
43	142-000-73	Wave Washer	1	6310(d109xd92x7Hx1.2t)	SK5	
44	052-000-50	Bearing (w/O-ring)	1	AC-6310ZC3		

* Indicates items included in set

PARTS LIST		SEWAGE & WASTEWATER PUMP			4/18/2014	
ITEM	PART No.	DESCRIPTION	QTY	SIZE	MATERIAL	NOTES
45	016-000-04	Lead Wire Protection Bush	2	d21xd52x11t	SBR	
46	058-000-23	Lead Wire Protection Plate	1	d120xd315x3t	SPCC	
47	055-002-02	Rotor	1Set			
48	147-000-38	Impeller Key	1	16x10x65L	SUS420	
49	053-001-67	Motor Protector	3	YS11A135A-D20	(H)	
50	056-005-56	Stator 460V-60Hz(USA)	1Set			
51	064-001-09	Motor Frame	1		FC	
52	142-427-13	Seal Washer	2	WD-12	SPC+NBR	
53	140-000-69	Hex.Bolt	2	M12x25	SS	
54	140-128-15	Hex.Bolt	6	M16x60	SUS304	
55	142-166-11	Spring Washer	6	M16	SUS304	
56	122-308-15	O-Ring	1	320xd5.7	NBR	*
57	140-055-78	Hex.Bolt	4	M8x25	SS	
58	142-163-34	Spring Washer	4	M8	SWRH	
59	133-001-19	Bearing Top Cover	1	WG1-4-37-BG/6-30-BG	FC	
60	121-000-27	Packing	2	4x5.5x274	Felt	*
61	052-000-55	Bearing	1Set	7314BDB+KL10		
62	142-247-17	Bearing Washer	1	AW14	SPCC	
63	141-079-13	Bearing Nut	1	AN14	SS	
64	122-149-16	O-Ring	1	G-190(189.3xd5.7)	NBR	*
65	060-001-25	Bearing Housing	1		FC	
66	122-265-19	O-Ring	1	335xd5.7	NBR	*
67	148-002-16	Grease Nipple	1	A-PT1/8	C3604	
68	122-024-14	O-Ring	1	P-25(24.7xd3.5)	NBR	
69	144-000-47	Grease Plug	1	M25x20	SUS304	
70	090-112-18	Leakage Sensor(Float)	1	OLV-5-2(B)		
71	142-293-18	Seal Washer	1	W-10	SUS304	
72	122-149-16	O-Ring	1	G-190(189.3xd5.7)	NBR	*
73	113-000-04	Grease Pan	1	CCKL21BG437/445/630	FC	
74	026-269-12	Oil Seal	1	TC-60789	NBR	
75	140-269-19	Hex.Socket Cap Bolt	4	M8x25	SUS304	
76	065-000-47	Outer Cover	1		SGPSS	
77	144-528-11	U-bolt	1	C-#20-M10	SUS304	
78	141-006-19	Hex.Nut	4	M10	SUS304	
79	122-359-11	O-Ring	1	445xd5.7	NBR	*
80	026-269-12	Oil Seal	1	TC-60789	NBR	
81	029-321-12	Casing Cover	1	200/250/300-22-6BG3	FC	
82	122-259-10	O-Ring	1	12xd3	NBR	*
83	035-102-30	Oil Plug	1	M12x16(B=21)	SUS304	
84	140-135-15	Hex.Bolt	4	M16x100	SUS304	
85	142-166-11	Spring Washer	4	M16	SUS304	
86	140-129-16	Hex.Bolt	4	M16x65	SUS304	
87	142-166-11	Spring Washer	4	M16	SUS304	
88	121-514-13	Seal Packing	6	d15.5xd27x4t	CR	*

* Indicates items included in set

PARTS LIST		SEWAGE & WASTEWATER PUMP			4/18/2014	
ITEM	PART No.	DESCRIPTION	QTY	SIZE	MATERIAL	NOTES
89	142-000-48	Washer	6	M16(d16.5xd31.5x5t)	SUS304	
90	142-166-11	Spring Washer	6	M16	SUS304	
91	140-129-16	Hex.Bolt	6	M16x65	SUS304	
92	122-259-10	O-Ring	2	12xd3	NBR	*
93	035-102-30	Oil Plug	2	M12x16(B=21)	SUS304	
94	025-000-51	Mechanical Seal	1	H-60	SiC	
95	143-028-13	Pan Screw	3	M5x10	SWRM	
96	030-134-10	Oil Lifter	1	H-60	SPCC	
97	122-266-10	O-Ring	1	460xd6	NBR	*
98	122-265-19	O-Ring	1	335xd5.7	NBR	*
99	122-259-10	O-Ring	1	12xd3	NBR	*
100	035-102-30	Oil Plug	1	M12x16(B=21)	SUS304	
101	029-317-15	Oil Casing	1	400-22-8BG3	FC	
102	122-267-11	O-Ring	1	495xd5	NBR	*
103	029-326-17	Casing Plate	1	200/250/300-22-6BG3	FC	
104	140-318-14	Hex.Socket Cap Bolt	3	M16x45	SUS304	
105	140-290-19	Hex.Socket Cap Bolt	3	M10x45	SUS304	
106	026-118-15	Oil Seal	1	TC-709513	NBR	
107	071-000-05	Shaft Sleeve	1	BK/BG(22-45KW)	SUS304	
108	034-426-14	Mouth Ring(Wear Ring)	1	d230xd282x25L(P.C.261)	FC	
109	140-233-14	Hex.Socket Cap Bolt	4	M5x12	SUS304	
110	122-137-11	O-Ring	1	G-130(129.4xd3.1)	NBR	*
111	026-267-10	Labyrinth Ring	1	d110xd140x13L	SUS304	
112	026-268-11	Oil Seal	1	TC-11014014	NBR	
113	021-000-88	Impeller (60Hz)	1	300BK630-63	FC	
114	145-035-19	Taper Pin	1	5x10	SUS304	
115	142-000-18	Impeller Fixing Washer	1	M20,d55	SUS304	
116	217-022-19	Fixing Plate	1	d75x3t M20(B=30)	SUS304	
117	140-232-13	Hex.Socket Cap Bolt	2	M5x10	SUS304	
118	140-148-11	Hex.Bolt	1	M20x50	SUS304	
119	020-948-14	Pump Casing	1	300B637-52/62	FC	
120	122-267-11	O-Ring	1	495xd5	NBR	*
121	140-233-14	Hex.Socket Cap Bolt	4	M5x12	SUS304	
122	034-430-11	Mouth Ring	1	d340xd383x35L(P.C.370)	FC	
123	022-714-15	Suction Cover	1	300-22-6BG3	FC	
124	142-165-10	Spring Washer	8	M12	SUS304	
125	140-098-15	Hex.Bolt	8	M12x35	SUS304	
126	142-131-17	Plain Washer	4	M20	SUS304	
127	142-168-13	Spring Washer	4	M20	SUS304	
128	140-150-16	Hex.Bolt	4	M20x60	SUS304	
129	023-000-14	Strainer Stand	1	BK(PC620)	FCD	
130	121-168-21	Packing	1	JIS5Kx300mm	NR	
131	142-166-11	Spring Washer	12	M16	SUS304	
132	140-128-15	Hex.Bolt	12	M16x60	SUS304	

* Indicates items included in set

PARTS LIST		SEWAGE & WASTEWATER PUMP			4/18/2014	
ITEM	PART No.	DESCRIPTION	QTY	SIZE	MATERIAL	NOTES
133	037-122-16	Discharge Bend	1	300x300mm	FC	
134	142-165-10	Spring Washer	4	M12	SUS304	
135	140-096-13	Hex.Bolt	4	M12x25	SUS304	
136	044-000-07	Bend Stand	1	P.C.100x392H	SGPSS	
		<Guide rail rail fittings>				
	099-104-14	Fitting Flange	1	TO-300	FC	
	121-168-21	Packing	1	JIS5Kx300mm	NR	
	140-318-14	Hex.Socket Cap Bolt	12	M16x45	SUS304	
	093-000-04	Guide Hook	1	TO-300/350	FCD	
	140-154-10	Hex.Bolt	4	M20x80	SUS304	
	142-168-13	Spring Washer	4	M20	SUS304	
	091-110-19	Duck Foot Bend(JIS10K)	1	TO-300	FC	
	094-110-18	Guide Support	1	TO-300/350	SS	
	140-128-15	Hex.Bolt	3	M16x60	SUS304	
	141-008-11	Hex.Nut	3	M16	SUS304	
	142-130-16	Plain Washer	3	M16	SUS304	
	096-113-17	Guide Connector	4	65mm	FC	
	140-099-16	Hex.Bolt	4	M12x40	SUS304	
	142-165-10	Spring Washer	4	M12	SUS304	
		<NPT Flange Version>				
	048-256-14	Welding Flange	1	JIS10Kx300mm	SS	
	121-111-29	Packing	1	JIS10Kx300mm	NR	
	140-176-21	Hex.Bolt	16	M22x90	SWRM	
	141-010-16	Hex.Nut	16	M22	SUS304	
	142-001-01	Spring Washer	16	M22	SWRH	
		<Packing O-Ring Set>				
	173-002-97	Packing O-Ring Set	1Set	(Marked by *)		
25	122-132-16	O-Ring (S.Box)	2	G-105(104.4xd3.1)	NBR	*
30	122-359-11	O-Ring (Fixing Plate/Out.Cover)	1	445xd5.7	NBR	*
34	121-513-12	Seal Packing (Fixing Plate Bolt)	6	d11.5xd21x4t	CR	*
35	122-353-15	O-Ring (Fixing Plate/M.Bracket)	1	310xd5.7	NBR	*
38	121-247-12	Packing (Air Tightness Test Plug)	1	d12.3xd18x2t	PE	*
42	122-353-15	O-Ring (M.Bracket/M.Frame)	1	310xd5.7	NBR	*
56	122-308-15	O-Ring (M.Frame/Brq.Housing)	1	320xd5.7	NBR	*
64	122-149-16	O-Ring (Bearing Top Cover/Bearing Housing)	1	G-190(189.3xd5.7)	NBR	*
66	122-265-19	O-Ring (Brq.Housing/Casing Cover)	1	335xd5.7	NBR	*
68	122-024-14	O-Ring (Plug)	1	P-25(24.7xd3.5)	NBR	*
72	122-149-16	O-Ring (Bearing Housing/Grease Pan)	1	G-190(189.3xd5.7)	NBR	*
79	122-359-11	O-Ring (Outer Cover/Casing Cover)	1	445xd5.7	NBR	*
82	122-259-10	O-Ring (Drain Plug)	1	12xd3	NBR	*
88	121-514-13	Seal Packing (Casing Cover Bolt)	6	d15.5xd27x4t	CR	*
92	122-259-10	O-Ring (Oil Plug)	2	12xd3	NBR	*
97	122-266-10	O-Ring (Casing Cover/O.Casing)	1	460xd6	NBR	*
98	122-265-19	O-Ring (Casing Cover/O.Casing)	1	335xd5.7	NBR	*
99	122-259-10	O-Ring (Drain Plug)	1	12xd3	NBR	*
102	122-267-11	O-Ring (O.Casing/P.Casing)	1	495xd5	NBR	*
110	122-137-11	O-Ring (Labyrinth Ring)	1	G-130(129.4xd3.1)	NBR	*
120	122-267-11	O-Ring (Pump Casing/Suction Cover)	1	495xd5	NBR	*

* Indicates items included in set

PARTS LIST		SEWAGE & WASTEWATER PUMP				4/18/2014
ITEM	PART No.	DESCRIPTION	QTY	SIZE	MATERIAL	NOTES
		Lubricant		Turbine Oil VG32 8,000ml		
		<Chain&Shackle>(SS)				
	095-152-15	Chain	1	13mmx5M	SS	
	011-109-17	Shackle	1	19mm	SS	
	095-110-11	Chain	1	13mm(9L)	SS	
	011-109-17	Shackle	2	19mm	SS	
		<Chain&Shackle>(SUS)				
	095-150-13	Chain	1	11mmx5M	SUS304	
	011-137-14	Shackle	1	16mm	SUS304	
	095-108-29	Chain	1	11mm(8L)	SUS304	
	011-137-14	Shackle	2	16mm	SUS304	
		<Cooling Pipe Set>				
	080-000-89	Cooling Pipe Set	1Set		SUS304	
		<Impeller Puller>				
	183-005-18	Impeller Puller	1	B No.5	FCD	

PARTS LIST		SEWAGE & WASTEWATER PUMP			4/18/2014	
ITEM	PART No.	DESCRIPTION	QTY	SIZE	MATERIAL	NOTES

EXPLODED VIEW

300BK630-63

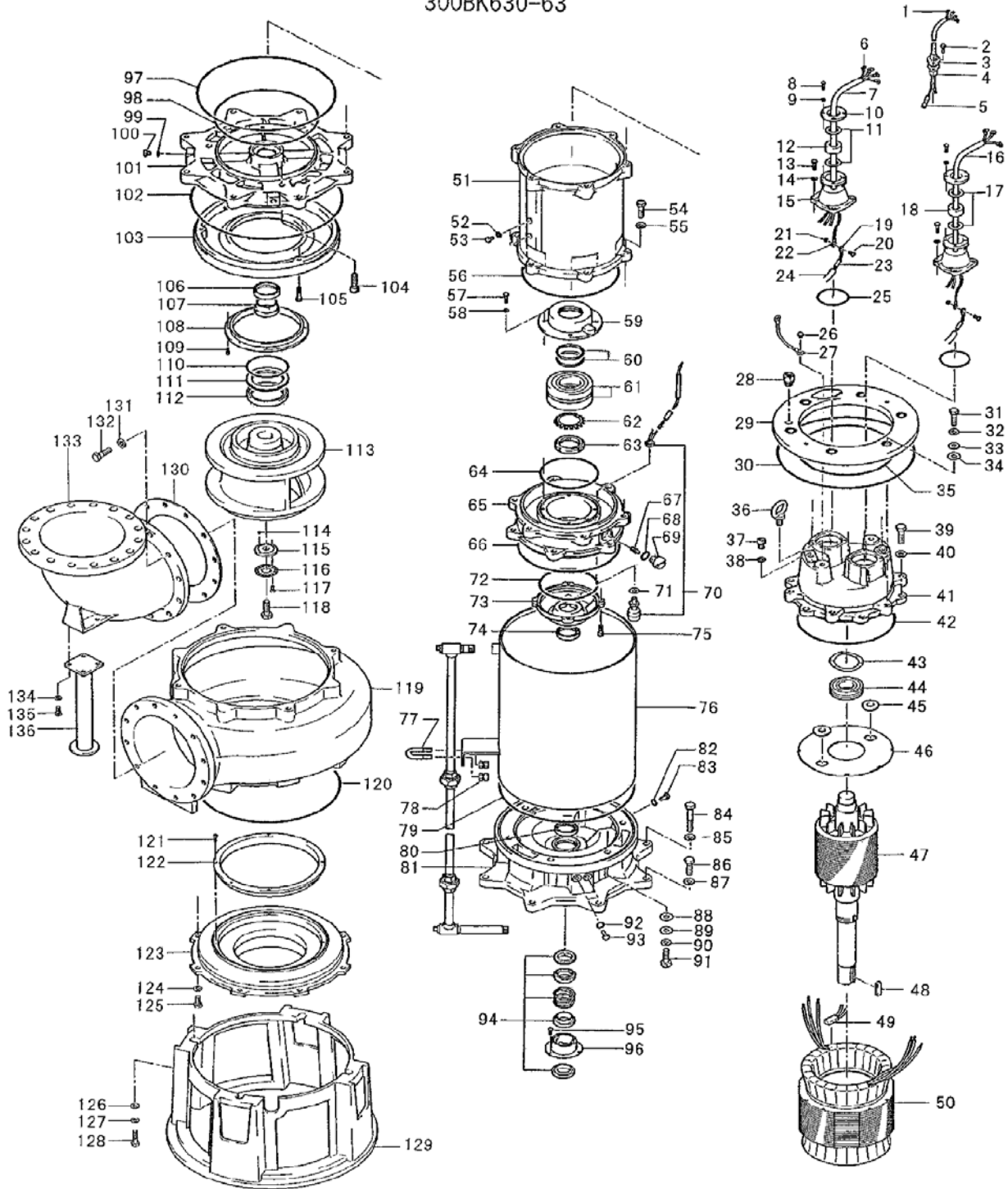

C-01332-1