

PARTS LIST		TITANIUM WASTEWATER PUMP			1/26/2022	
ITEM	PART No.	DESCRIPTION	QTY	SIZE	MATERIAL	NOTES
1	001-912-36	Cabtyre Cable Set (32') 60Hz (USA)	1	VCT4Cx1.25mm2	TMT	
2	143-000-37	Hex.Tapping Screw	2	M5x20	Titanium	
3	003-100-26	Gland	1	LB/TM	Titanium	
4	051-000-47	Head Cover	1		Resin	
5	140-000-15	Hex.Bolt (w/Plain Washer)	4	M6x30(22L)	Titanium	
6	122-004-18	O-Ring	4	P-6(5.8xd1.9)	NBR	*
7	143-000-37	Hex.Tapping Screw	2	M5x20	Titanium	
8	109-129-19	Float Support Bush	2	d14	Rubber	
9	106-484-16	Float Set	1Set	AOT2-2(350L/400L)		
10	143-143-28	Truss Tapping Screw	2	M4x16(D=8)	Titanium	
11	109-000-01	Float Support Pipe	1	VP-14x250L(w/Hole, Black)	PVC	
12	143-143-28	Truss Tapping Screw	1	M4x16(D=8)	Titanium	
13	143-000-32	Pan Tapping Screw	2	M4x14	Titanium	
14	109-000-20	Holder	1		Resin	
15	114-000-08	Power Relay	1	LY-3F(AC24V)		
16	143-152-17	Truss Tapping Screw	2	M3x8	SWCH	
17	115-000-77	Transformer 208/220V-60Hz(USA)	1	AIE200/20-3	(T)	replaces OLD# 115-000-07
17	115-000-17	Transformer 460V-60Hz(USA)	1	AI440/20-3	(T)	
18	143-152-17	Truss Tapping Screw	2	M3x8	SWCH	
19	143-085-34	Pan Screw (w/Spring Washer)	1	M4x6	C3604	
20	009-207-19	Earth Terminal	1Set	AWG16x175L(CEE)		
21	143-000-06	Pan Screw	4	M5x107(20L)	SWRM	
22	053-430-10	Motor Protector 208/220V-60Hz(USA)	1	KA311-DAVL65	(T)	
22	053-000-42	Motor Protector 460V-60Hz(USA)	1	KA311-DPTL76	(T)	
23	143-136-15	Truss Screw	2	M4x10	SWRM	
24	050-000-02	Motor Bracket	1		ADC	
25	121-471-17	Packing	1	d126.6xd135.6x6t	NBR	*
26	056-000-41	Stator(w/M.Frame) 208/220V-60Hz(USA)	1Set			
26	056-000-77	Stator(w/M.Frame) 460V-60Hz(USA)	1Set			
27	071-000-01	Collar	1	37L	SECC	
28	142-192-16	Wave Washer	1	6201(D=32,t=0.4)	SK5	
29	052-100-15	Bearing	1	6201ZZC3		
30	055-004-95	Rotor	1Set	w/Bearing		interchangable with OLD part# 055-003-38
31	061-157-15	Bearing Collar	1	d15.1xd21x1.6t	SPCC	
32	052-152-12	Bearing	1	6302ZZC3		
33	060-001-37	Bearing Housing	1		ADC	
34	025-000-78	Mechanical Seal	1	W-14HL (RoHS)	SSiC	replaces OLD part# 025-290-19
35	030-000-01	Oil Lifter	1	VANCS2	Resin	
36	121-001-12	Packing	1	VANCS2	NBR	*

\* Indicates items included in set

PARTS LIST		TITANIUM WASTEWATER PUMP			1/26/2022	
ITEM	PART No.	DESCRIPTION	QTY	SIZE	MATERIAL	NOTES
37	035-128-16	Oil Plug	1	M10x15	Titanium	
38	121-246-11	Packing	1	d10.3xd16x2t	PE	*
39	140-000-11	Hex.Bolt (w/Plain Washer)	4	M6x25	Titanium	
40	029-000-95	Oil Casing	1	VANCS2	Resin	
41	143-000-08	Truss Screw (w/O-Ring)	4	M6x20(P-5,NBR)	Titanium	
42	142-360-17	Impeller Fixing Washer	1	d11.2xd22.5x0.8t	Titanium	
43	021-G27-20	Impeller (60Hz)	1	50TMA2.25-63	Resin	
44	143-140-25	Truss Screw (w/Plain Washer)	1	M6x12	Titanium	
45	122-000-07	O-Ring	1	122xd3.0	NBR	*
46	140-000-12	Hex.Bolt (w/Plain Washer)	2	M8x45	Titanium	
47	048-274-18	Screwed Flange	1	NPT-2(P.C.90)	Resin	
48	121-469-12	Packing	1	P.C.90xd58x2t	NR	*
49	020-000-07	Pump Casing	1	(40/50)TM.25/.4/.75	Resin	
50	023-000-01	Strainer	1	(40/50)PN/TM/TQ2. 25/.4/.75	Resin	
51	143-000-11	Truss Tapping Screw	2	M4x18	Titanium	
	173-000-07	<b>Packing O-Ring Set</b>	1Set	(Marked by *)		
6	122-004-18	O-Ring (Head Cover Fixing Bolt)	4	P-6(5.8xd1.9)	NBR	*
25	121-471-17	Packing (Head Cover/M.Frame)	1	d126.6xd135.6x6t	NBR	*
36	121-001-12	Packing (M.Frame/O.Casing)	1	VANCS2	NBR	*
38	121-246-11	Packing (Oil Plug)	1	d10.3xd16x2t	PE	*
41	122-003-17	O-Ring (P.Casing Fixing Screw)	4	P-5(4.8xd1.9)	NBR	*
45	122-000-07	O-Ring (O.Casing/P.Casing)	1	122xd3.0	NBR	*
48	121-469-12	Packing (Screwed Flange)	1	P.C.90xd58x2t	NR	*
		Lubricant		Liquid Paraffin VG32 240ml		

PARTS LIST		TITANIUM WASTEWATER PUMP			1/26/2022	
ITEM	PART No.	DESCRIPTION	QTY	SIZE	MATERIAL	NOTES

## EXPLODED VIEW

50TMA2. 25-53/63 50TMA2. 25-52/62  
 50TMA2. 4-53/63 50TMA2. 4-52/62  
 50TMA2. 75-53/63 50TMA2. 75-52/62

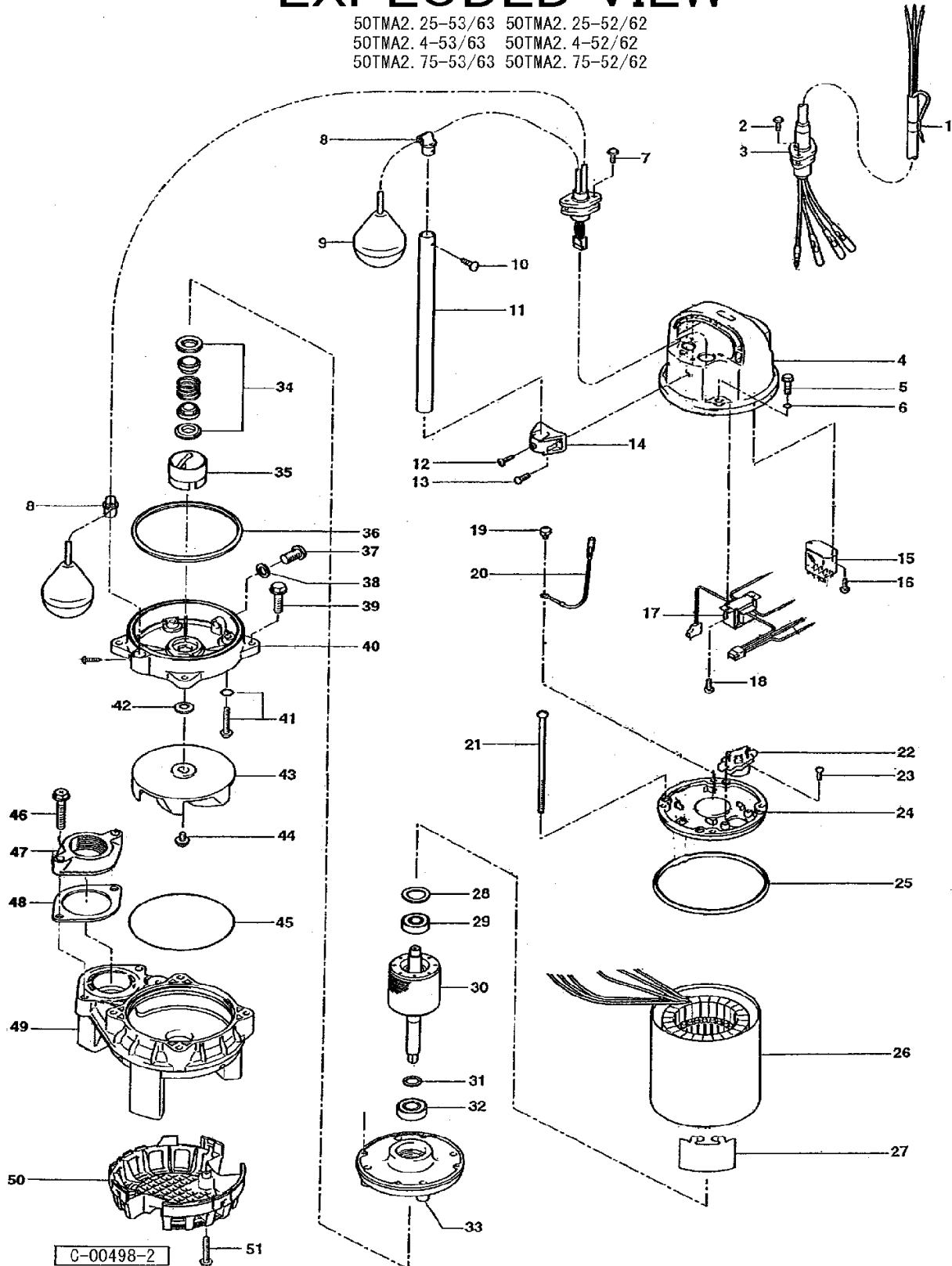

C-00498-2