

PARTS LIST		STAINLESS STEEL DEWATERING PUMP			5/10/2023	
ITEM	PART No.	DESCRIPTION	QTY	SIZE	MATERIAL	NOTES
1		Cable Clip	2		SUS316	
		Cable Clip Rubber	1	115x100x2t	FKM	
2	141-005-21	Hex.Nut	4	M8	SUS316	
3	140-055-36	Hex.Bolt	4	M8x25	SUS316	
4	009-113-17	Terminal	6	R-38-10	CU	
5	009-117-11	Terminal	1	R-22-6	CU	
6	009-116-10	Terminal	2	R-2-4	CU	
7	001-303-12	Cabtyre Cable (15m)	1	2PNCT.F Multi-core 10Cx30mm2		
8	011-000-07	Shackle	1	6mm	SUS316	
9		Chain	1	d5(9-Link)	SUS316	
10	072-108-31	Eye Bolt	2	M30	SUS316	
		Washer		d31xd59x0.3t/0.5t	SUS316	
11		Hex.Bolt	4	M8x40	SUS316	
12	141-005-21	Hex.Nut	4	M8	SUS316	
13	003-LH837-14-60	Gland	1	No.6	SCS14	
14	004-171-18	Cable Bush	1	d42.5xd65x25l	CR	
15	005-137-15	Bush Washer	1	d43xd62x3.2t	SPC	
16	006-LH837-14-60	Stuffing Box	1		SCS14	
17	140-076-20	Hex.Bolt	4	M10x30	SUS316	
18	142-164-22	Spring Washer	4	M10	SUS316	
19		O-Ring	1	140xd3.5	FKM	*
20	141-004-59	Hex.Nut	6	M6	SWRM	
21	140-029-28	Hex.Bolt	6	M6x10	SWRM	
22	009-167-16	Terminal	6	R-38-S6	CU	
23	009-106-17	Terminal	6	R-8-6	CU	
24	143-041-12	Pan Screw	1	M6x8	SWRM	
25	009-168-17	Terminal	1	R-22-S6	CU	
26	009-115-19	Connector	2	PC-4020F		
27	009-114-18	Connector	2	PC-4020M		
28	002-000-18	Heat Shrink Tube (Sold per meter)	m	W3F2(3/4IN)	(V/m)	
29		Lead Wire	1	8SQ(G/Y)		
	009-106-17	Terminal	2	R-8-6	CU	
	200-000-23	Electical tape (30M)		540S(0.18T-30Wx30M)		
	002-164-12	Heat Shrink Tube (Sold per meter)	m	A4(d13x0.3t)	(V/m)	
30	141-008-24	Hex.Nut	6	M16	SUS316	
31	142-166-24	Spring Washer	6	M16	SUS316	
32		Stud Bolt	6	M16x45(28/24)(JIS)	SUS316	
33	037-LH837-14-60	Center-Flange Discharge Pipe	1	LH637/645	SUS316	

PARTS LIST		STAINLESS STEEL DEWATERING PUMP			5/10/2023	
ITEM	PART No.	DESCRIPTION	QTY	SIZE	MATERIAL	NOTES
34	121-500-16	Packing	1	LH637/875	THREE SHEET	*
35		Stay (Right)	1	LH637/645 (Right)	SUS316	
36	140-126-26	Hex.Bolt	2	M16x50	SUS316	
37	140-124-24	Hex.Bolt	2	M16x40	SUS316	
38	142-166-24	Spring Washer	2	M16	SUS316	
39	142-166-24	Spring Washer	2	M16	SUS316	
40	141-008-24	Hex.Nut	2	M16	SUS316	
41		Stay (Left)	1	LH637/645 (Left)	SUS316	
42		Oil Plug	2	M12x14	SUS316	
43	121-395-16	Packing	1	d11.8xd18x3t	PE	*
44		Hex.Bolt	2	M10x120	SUS316	
45	142-164-22	Spring Washer	3	M10	SUS316	
46		Washer	2	23.5x10.5x5t	SUS316	
46		Packing	2	17x9.5x4t	FKM	*
47	140-076-20	Hex.Bolt	1	M10x30	SUS316	
48	142-164-22	Spring Washer	3	M10	SUS316	
49	140-130-23	Hex.Bolt	6	M16x70	SUS316	
50	142-166-24	Spring Washer	6	M16	SUS316	
51		Head Cover	1		SCS14	
52		O-Ring	1	435xd6	FKM	*
53		O-Ring	1	234.3xd5.7	FKM	*
54	016-114-10	Lead Wire Protection Bush	1	GH-637/837(for 5 cores)	SBR	
55	016-113-19	Lead Wire Protection Bush	1	GH-422/430(for 3 cores)	SBR	
56	140-128-28	Hex.Bolt	6	M16x60	SUS316	
57	142-166-24	Spring Washer	6	M16	SUS316	
58		Motor Bracket	1		SCS14	
59		O-Ring	1	442xd6	FKM	*
60	142-280-12	Wave Washer	1	6310	SK5	
61	052-001-09	Bearing	1	6310ZZC3 (TWN)		
62	122-133-17	O-Ring (Upp. Bearing)	1	G-110(109.4xd3.1)	NBR	*
63		Outer Cover	1	GH-37/45KW	SUS316	
64		Rotor	1Set			
65		Impeller Key	1	10x8x50L	SUS316	
66	053-309-19	Motor Protector	3	9700K-46-215		
67		Stator 460V-60Hz	1Set			
68	122-107-12	O-Ring	1	P-315(314.5xd8.5)	FKM	*
69		Motor Frame	1		SCS14	
70	122-259-23	O-Ring	1	12xd3	FKM	*

PARTS LIST		STAINLESS STEEL DEWATERING PUMP			5/10/2023	
ITEM	PART No.	DESCRIPTION	QTY	SIZE	MATERIAL	NOTES
71		Stator Set Bolt	1	M12(B=21)	SUS316	
72		O-Ring	1	G-200(199.3xd5.7)	FKM	*
73		O-Ring	1	G-280(279.3xd5.7)	FKM	*
74	140-055-49	Hex.Bolt	4	M8x25	SWRM	
75		Bearing Fixing Plate	1		SS	
76		Bearing	1Set	7314L1DBP5		
77	142-247-17	Bearing Washer	1	AW14	SPCC	
78	141-079-13	Bearing Nut	1	AN14	SS	
79	026-272-18	Oil Seal	1	SC-50689	NBR	
80		O-Ring	1	442xd6	FKM	*
81	140-103-27	Hex.Bolt	6	M12x60	SUS316	
82	142-165-23	Spring Washer	6	M12	SUS316	
83		Bearing Housing	1		SCS14	
84		Oil Plug	2	M12x14	SUS316	
85	121-395-16	Packing	2	d11.8xd18x3t	PE	*
86		O-Ring	1	442xd6	FKM	*
87	142-166-24	Spring Washer	6	M16	SUS316	
88	140-127-27	Hex.Bolt	6	M16x55	SUS316	
89	025-001-29	Mechanical Seal	1	HT-4550N	SiC - FKM	
90	143-070-23	Pan Screw	2	M5x6	SWRM	
91	030-136-12	Oil Lifter	1	HT-4550	Resin	
92	143-070-10	Pan Screw	6	M5x6	SWRM	
93	030-145-14	Seal Stopper	1	HT-4550	SPCC	
94		O-Ring	1	295xd4	FKM	*
95	029-LH837-14-60	Oil Casing	1	LH-37/45KW	SCS14	
96	142-165-23	Spring Washer	6	M12	SUS316	
97	140-097-27	Hex.Bolt	6	M12x30	SUS316	
98		O-Ring	1	295xd4	FKM	*
99		Shaft Sleeve	1	GH-370H/L	SUS316	
100	020-LH837-14-60	Pump Casing	1	LH637/645.w/Labyrinth Ring	SCS14	
101		Oil Seal	1	TCN-487012	FKM	
102		Shaft Sleeve	1	GH-370H/L	SUS316	
103		Impeller Shim		d41.5xd59x0.3t/0.5t	SUS316	
104	021-011-96	Impeller (60Hz)	1	LH637-60	SCS14	
105	142-001-22	Nord-Lock Washer	1	M30	SUS316	
106	-	-	-	-	-	
107		Impeller Nut	1	M30,P3.5(B=46,Hex.Cap Nut)	SUS316	

PARTS LIST		STAINLESS STEEL DEWATERING PUMP			5/10/2023	
ITEM	PART No.	DESCRIPTION	QTY	SIZE	MATERIAL	NOTES
108	022-LH837-14-60	Suction Plate	1		SUS316	
109		O-Ring	1	180xd3.1	FKM	*
110		O-Ring	1	305xd5	FKM	*
111	033-LH837-14-60	Suction Cover	1	GH-637	SCS14	
112	142-165-23	Spring Washer	6	M12	SUS316	
113	140-097-27	Hex.Bolt	6	M12x30	SUS316	
114	142-163-21	Spring Washer	3	M8	SUS316	
115	141-005-21	Hex.Nut	3	M8	SUS316	
116		Hex.Bolt	3	M8x40	SUS316	
117	141-005-21	Hex.Nut	3	M8	SUS316	
118	140-055-36	Hex.Bolt	3	M8x25	SUS316	
119		Stud Bolt	3	M12x120(20/20)	SUS316	
120	023-LH837-14-60	Strainer Stand	1	GH-370/450H	SUS316	
121	142-165-23	Spring Washer	3	M12	SUS316	
122	141-007-23	Hex.Nut	3	M12	SUS316	
123	141-007-23	Hex.Nut	3	M12	SUS316	
124	142-129-38	Plain Washer	3	M12	SUS316	
125	142-165-23	Spring Washer	3	M12	SUS316	
126	043-102-19	Cathodic Protection Plate	3	AB-1HS(75x70x20t)	AL	
127	140-096-26	Hex.Bolt	3	M12x25	SUS316	
		<NPT Flange Version>				
	032-LH837-14-60	Screwed Flange	1	NPT-6(JIS10K)	SCS14	
		Packing	1	JIS10Kx150mm	FKM	
		Hex.Bolt	8	M20x85	SUS316	
	142-168-42	Spring Washer	8	M20	SUS316	
	141-009-41	Hex.Nut	8	M20	SUS316	
	173-LH837-14-60	Packing O-Ring Set	1Set			
19		O-Ring	1	140xd3.5	FKM	*
34	121-500-16	Packing (Discharge Pipe/Head Cover)	1	LH637/875	THREE SHEET	*
43	121-395-16	Packing	1	d11.8xd18x3t	PE	*
46		Packing	2	17x9.5x4t	FKM	*
52		O-Ring	1	435xd6	FKM	*
53		O-Ring	1	234.3xd5.7	FKM	*
59		O-Ring	1	442xd6	FKM	*
62	122-133-17	O-Ring (Upp. Bearing)	1	G-110(109.4xd3.1)	NBR	*
68	122-107-12	O-Ring	1	P-315(314.5xd8.5)	FKM	*
70	122-259-23	O-Ring	1	12xd3	FKM	*

PARTS LIST		STAINLESS STEEL DEWATERING PUMP				5/10/2023
ITEM	PART No.	DESCRIPTION	QTY	SIZE	MATERIAL	NOTES
72		O-Ring	1	G-200(199.3xd5.7)	FKM	*
73		O-Ring	1	G-280(279.3xd5.7)	FKM	*
80		O-Ring	1	442xd6	FKM	*
85	121-395-16	Packing	2	d11.8xd18x3t	PE	*
86		O-Ring	1	442xd6	FKM	*
94		O-Ring	1	295xd4	FKM	*
98		O-Ring	1	295xd4	FKM	*
109		O-Ring	1	180xd3.1	FKM	*
110		O-Ring	1	305xd5	FKM	*
		Packing	1	JIS10Kx150mm	FKM	*
		Lubricant		Turbine Oil VG32 5,000ml		
	183-011-17	Impeller Puller	1	A No.6 2"	FC	

PARTS LIST		STAINLESS STEEL DEWATERING PUMP			5/10/2023	
ITEM	PART No.	DESCRIPTION	QTY	SIZE	MATERIAL	NOTES

J4-49272-1

EXPLODED VIEW

LH637-14-60

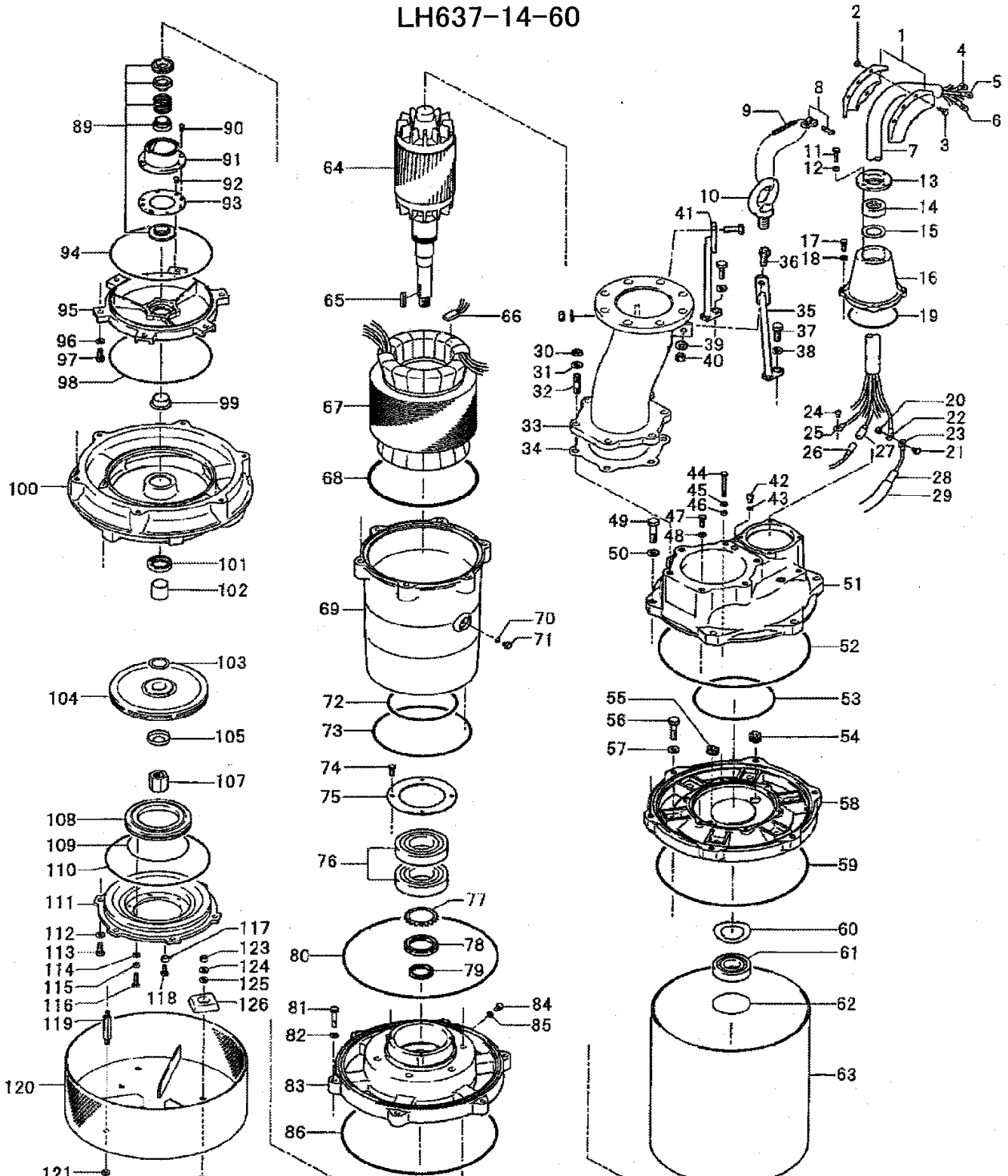

* Indicates items included in set



MODEL LH837-14-60

PARTS LIST		STAINLESS STEEL DEWATERING PUMP					5/10/2023
ITEM	PART No.	DESCRIPTION	QTY	SIZE	MATERIAL	NOTES	
	122	127	87				
	C-00192-1		88				