

PARTS LIST		VANCS WASTEWATER PUMP				6/18/2019
ITEM	PART No.	DESCRIPTION	QTY	SIZE	MATERIAL	NOTES
1	001-803-20	Cabtyre Cable Set (32')	1	VCT4Cx1.25mm2	LBT	
2	143-000-33	Hex.Tapping Screw	2	M5x20	SUS304	
3	003-190-10	Gland	1		SUS316	
4	051-000-47	Head Cover	1		Resin	
5	140-000-07	Hex.Bolt (w/Plain Washer)	4	M6x30(22L)	SUS304	
6	122-004-18	O-Ring	4	P-6(5.8xd1.9)	NBR	*
7	143-000-33	Hex.Tapping Screw	2	M5x20	SUS304	
8	109-129-19	Float Support Bush	2	d14	Rubber	
9	143-143-15	Truss Tapping Screw	2	M4x16(D=8)	SUS304	
10	106-483-15	Float Set	1Set	AO2-3(400L/300L/400L)		
11	109-000-02	Float Support Pipe	1	VP-14x300L(w/Hole, Black)	VP	
12	109-130-13	Float Support Bush	1	d14	Rubber	
13	143-143-15	Truss Tapping Screw	1	M4x16(D=8)	SUS304	
14	109-000-20	Holder	1		Resin	
15	143-143-15	Truss Tapping Screw	1	M4x16(D=8)	SUS304	
16	143-174-15	Tapping Screw	2	M4x14	SUS304	
17	114-000-10	Power Relay	1	LY-2F(DC24V)		
18	143-152-17	Truss Tapping Screw	2	M3x8	SWCH	
19	115-000-10	Transformer 200-220V-60Hz	1	WI200/20-3	(T)	115-000-87 is interchangeable
	115-000-25	Transformer 460V-60Hz	1	WI440/20-3	(T)	115-000-91 is interchangeable
20	143-152-17	Truss Tapping Screw	2	M3x8	SWCH	
21	143-152-17	Truss Tapping Screw	3	M3x8	SWCH	
22	114-000-06	Relay Unit	1	Control Panel for Auto-Alternate Operati		
23	143-085-34	Pan Screw (w/Spring Washer)	1	M4x6	C3604	
24	009-001-24	Earth Terminal	1Set	1.25mm2x195L		
25	143-000-07	Pan Screw	4	M5x132(20L)	SWRM	
26	143-136-15	Truss Screw	2	M4x10	SWRM	
27	053-000-09	Motor Protector 200-220V-60Hz	1	KA311-DAVL78C	(T)	
	053-001-53	Motor Protector 460V-60Hz	1	KA311-DATL65C	(T)	
28	050-000-02	Motor Bracket	1		ADC	
29	121-471-17	Packing	1	d126.6xd135.6x6t	NBR	*
30	056-008-07	Stator (w/M.Frame) 200-220-60Hz	1Set			
	056-008-12	Stator (w/M.Frame) 460-60Hz	1Set			
31	071-000-01	Collar	1	37L	SECC	

\* Indicates items included in set

PARTS LIST		VANCS WASTEWATER PUMP				6/18/2019
ITEM	PART No.	DESCRIPTION	QTY	SIZE	MATERIAL	NOTES
32	142-000-91	Wave Washer	1	6201 (D=30.6,t=0.35)	SK5	
33	052-100-15	Bearing	1	6201ZZC3		
34	055-002-94	Rotor	1Set	w/Bearing		
35	061-157-15	Bearing Collar	1	d15.1xd21x1.6t	SPCC	
36	052-152-12	Bearing	1	6302ZZC3		
37	060-001-37	Bearing Housing	1		ADC	
38	025-000-78	Mechanical Seal	1	W-14HL (ROHS)	SiC+CCBN	replaces OLD part# 025-290-19
39	030-000-01	Oil Lifter	1	VANCS2	Resin	
40	121-001-12	Packing	1	VANCS2	NBR	*
41	035-127-15	Oil Plug	1	M10x15	SUS304	
42	121-246-11	Packing	1	d10.3xd16x2t	PE	*
43	140-000-03	Hex.Bolt (w/Spring Washer)	4	M6x25	SUS304	
44	029-000-95	Oil Casing	1	VANCS2	Resin	
45	143-000-26	Truss Screw (w/O-Ring)	4	M6x20(P-5,NBR)	SUS304	*
46	142-354-18	Conical Spring Washer	1	d11.2xd22.5x0.8t	SUS304	
47	021G3329	Impeller (60Hz)	1	50PSFW2.75-62	Resin	
48	143-140-12	Truss Screw (w/Plain Washer)	1	M6x12	SUS304	
49	122-000-07	O-Ring	1	122xd3.0	NBR	*
50	140-000-09	Hex.Bolt (w/Spring Washer)	2	M8x45	SUS304	
51	048-274-18	Screwed Flange	1	NPT-2(P.C.90)	Resin	
52	121-469-12	Packing	1	P.C.90xd58x2t	NR	*
53	020-000-06	Pump Casing	1	(40/50)PN/PSF2.25/.4/.75	Resin	
54	023-000-02	Strainer	1	(40/50)PSF(A)(W)2.25/.4/.75	Resin	
55	143-000-10	Truss Tapping Screw	2	M4x18	SUS304	
	173-000-07	<b>Packing O-Ring Set</b>	1Set	(Marked by *)		
6	122-004-18	O-Ring (Head Cover Fixing Bolt)	4	P-6(5.8xd1.9)	NBR	*
29	121-471-17	Packing (Head Cover/M.Frame)	1	d126.6xd135.6x6t	NBR	*
40	121-001-12	Packing (M.Frame/O.Casing)	1	VANCS2	NBR	*
42	121-246-11	Packing (Oil Plug)	1	d10.3xd16x2t	PE	*
45	122-003-17	O-Ring (P.Casing Bolt)	4	P-5(4.8xd1.9)	NBR	*
49	122-000-07	O-Ring (O.Casing/P.Casing)	1	122xd3.0	NBR	*
52	121-469-12	Packing (Screwed Flange)	1	P.C.90xd58x2t	NR	*
		Lubricant		Turbine Oil VG32 240ml		

PARTS LIST		VANCS WASTEWATER PUMP				6/18/2019
ITEM	PART No.	DESCRIPTION	QTY	SIZE	MATERIAL	NOTES

## EXPLODED VIEW

50PSFW2.75-62

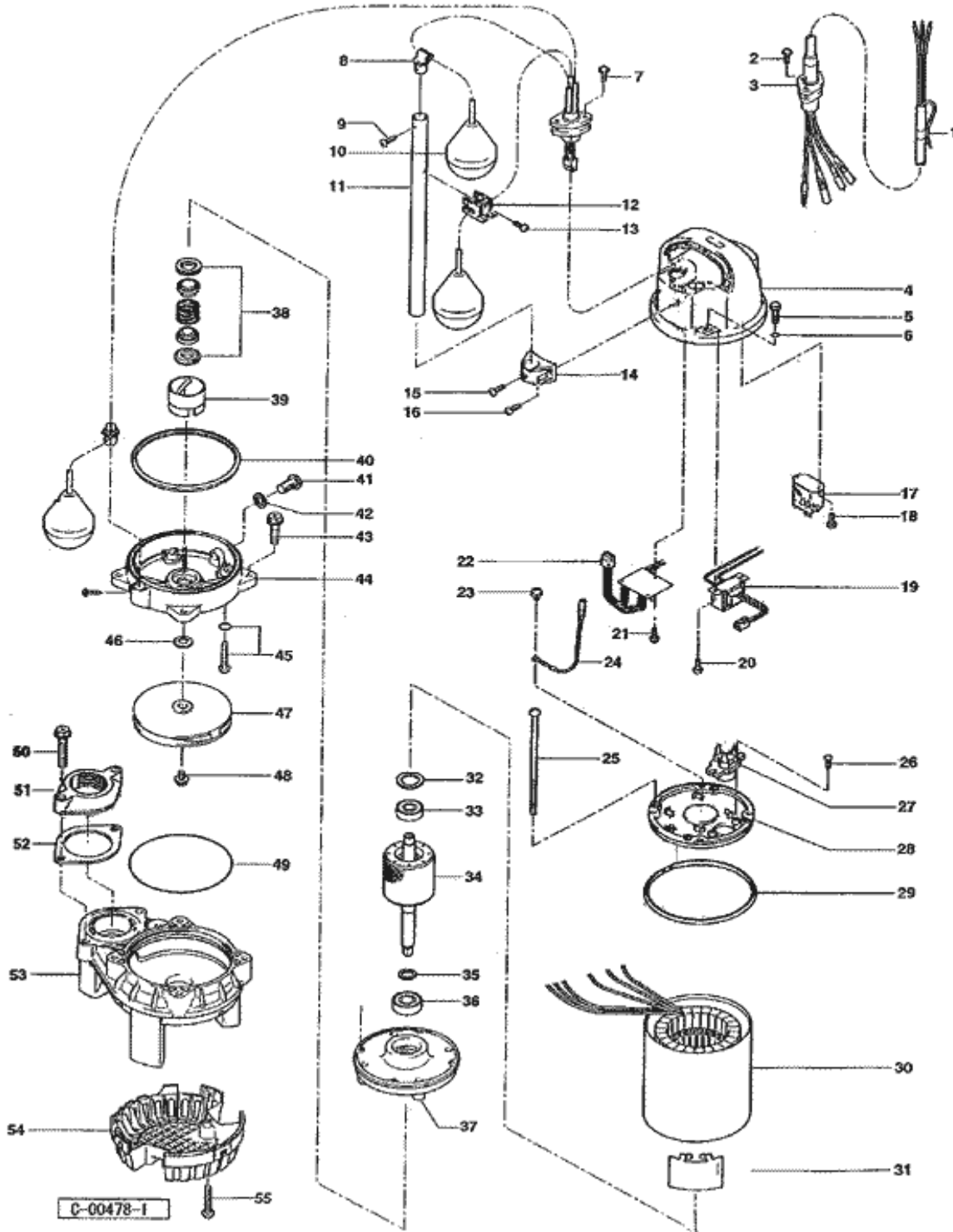

\* Indicates items included in set